

# PMP1BKUMB4-(x) - Under Mirror Mount Bracket Kit (each)

## 2021-2023 Chevrolet Tahoe Police Pursuit & Civilian Vehicles

For 3" mpower® Quick Mount

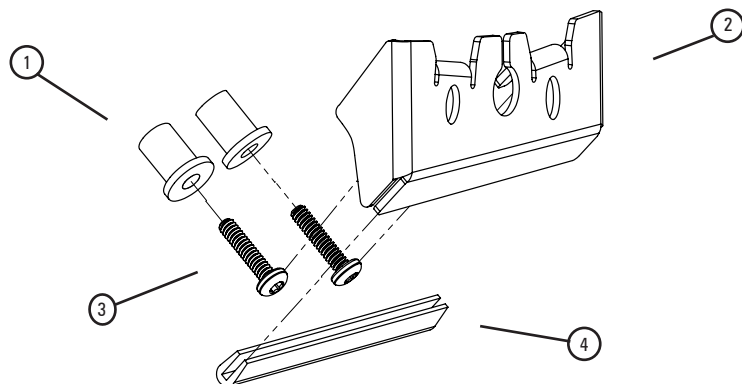

PMP1BKUMB4-D IS SHOWN\*

### ⚠ WARNING

- HIGH CURRENT interconnects must be properly terminated. Poor crimp quality can cause heat build-up and fire. Follow crimp connector manufacturer instructions.
- DO NOT install this product or route any wires in the Air Bag Deployment Zone. Refer to vehicle Owner's Manual for deployment zones.
- Do NOT use system to disconnect headlights, brake lights or other safety equipment.
- Unit may become hot to touch during normal operation.
- Failure to properly install connectors, fuses or wiring may cause vehicle failure or fire.
- Installation must only be performed by trained technician. Installer must determine vehicle wiring configuration and proper integration of system.
- Use proper wire gauge. All power wires connecting to positive (+) or negative (-) battery terminal or local chassis ground (-) must be sized to supply at least 125% of max. current and properly fused at power source.
- Install protective grommets when routing wire through firewall or metal.

### INTRODUCTION:

mpower® Fascia Light Features:

- 3" Quick Mount Options available for this bracket design
- Collaboration with Dow Corning® to develop ClearDuty™ optical design
- Greater resistance to gravel pitting, scratching, or cracking
- Improved sealing to prevent water from entering light
- Higher UV and thermal stability to prevent lens from yellowing over time

PART#	YEAR, MAKE, AND MODEL	*COMPATIBLE WITH...
PMP1BKUMB4-(D) (002BR1012)	2021-2022 Chevrolet Tahoe	3" mpower® Quick Mount, Driver Side
PMP1BKUMB4-(P) (002BR1013)	2021-2022 Chevrolet Tahoe	3" mpower® Quick Mount, Passenger Side

### CONTENTS

ITEM#	QTY	COMPONENT
1	2	NEOPRENE RIVET NUT 6-32
2	1	BRACKET
3	2	6/32" - 5/8" SCREW
4	1	Thin Trim
	1	PRODUCT WARNING CARD
	1	INSTRUCTION SHEET

\*Installation instructions are for the driver's side bracket (PMP1BKUMB4-D). Installation for the driver side is the same.

### NOTICE:

Installers and users must comply with all applicable federal, state and local laws regarding use and installation of warning devices.

*Improper use or installation may void warranty coverage.*

*To review our Limited Warranty Statement & Return Policy for this or any SoundOff Signal product, visit our website at [www.soundoffsignal.com/tech-services/returns/](http://www.soundoffsignal.com/tech-services/returns/).*

*If you have questions regarding this product, contact **Technical Services**, Monday - Friday, 8 a.m. to 5 p.m. ET at 1.800.338.7337 (press #4).*

*Questions or comments that do not require immediate attention may be emailed to [techservices@soundoffsignal.com](mailto:techservices@soundoffsignal.com).*

# SoundOff Signal

1.800.338.7337 / [www.soundoffsignal.com](http://www.soundoffsignal.com)

1

ENHANCING SAFETY THROUGH INNOVATION

PMP1BKUMB4-x 1122 REV B

# PMP1BKUMB4-(x) - Under Mirror Mount Bracket Kit (each) 2021-2023 Chevrolet Tahoe Police Pursuit & Civilian Vehicles

For 3" mpower® Quick Mount

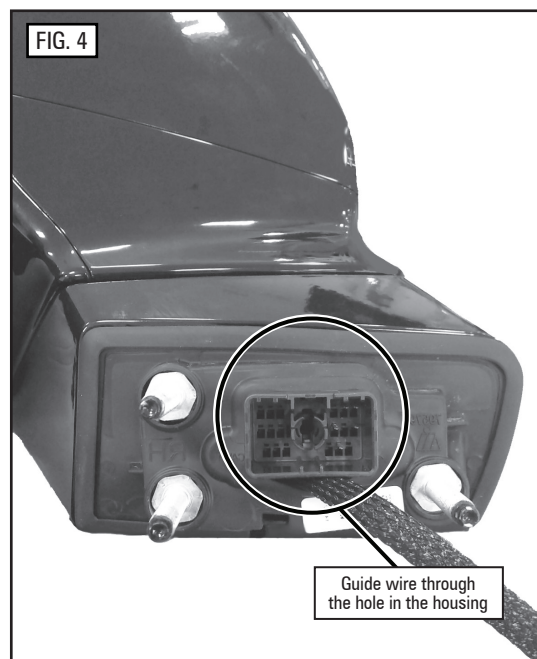
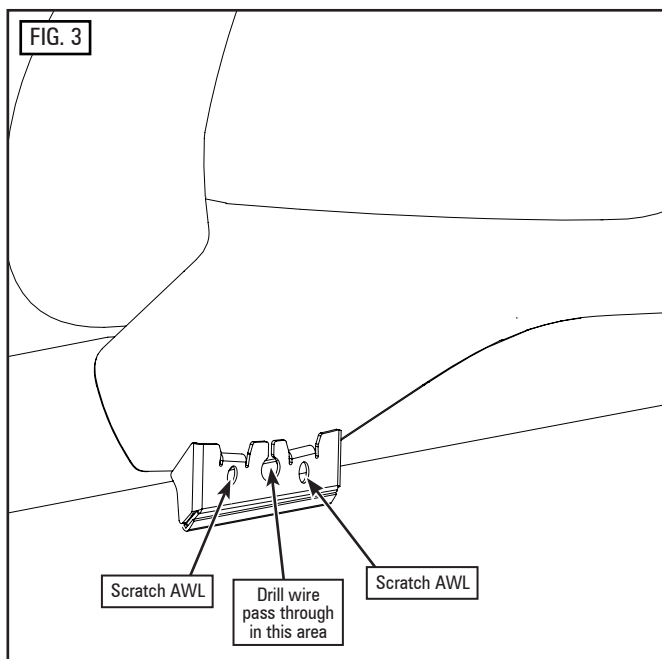
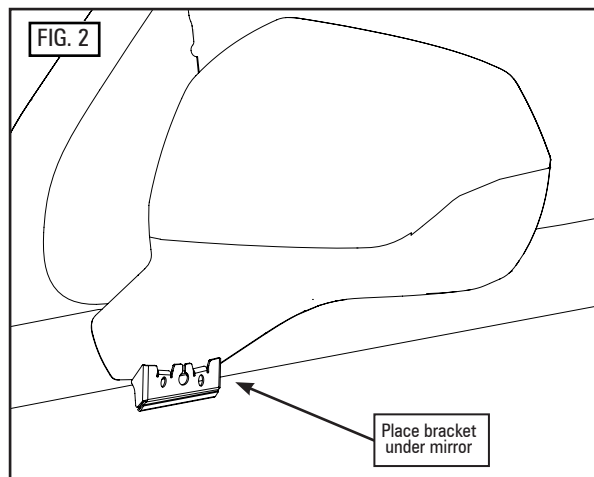
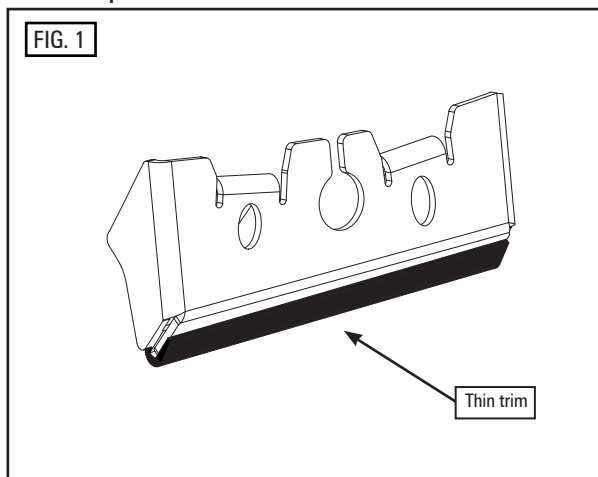

## INSTALLATION

**PRO TIP:** To prevent the metal bracket from contacting the painted surfaces of the vehicle, the included thin trim can be placed along the lower edge of the bracket, as shown in FIG. 1.

1. Position the bracket under the mirror so that it looks similar to the image shown in FIG. 2.
2. Use a scratch awl to mark the location of the holes that will be drilled in the mirror housing, as shown in FIG. 3. These will be at the end of the slots that are accessible through the ellipses on the face of the bracket. Identify the gap between the two bracket tabs where a wire pass through can be drilled.

**PRO TIP:** To reach the scratch awl locations, angle the scratch awl upwards when entering the left and right openings on the bracket.

3. Once the holes are marked on the mirror housing, remove the bracket and drill the holes using a 5/16" drill bit in the marked locations. Also, drill a hole between the two holes, previously drilled, that the wires can pass through. When drilling into the mirror housing, do not drill deeper than the housing. For reference, the housing is less than 0.15 in thick.
4. Now that the holes have been drilled, remove the mirror from the vehicle. Guide the wire through the wire pass through hole you drilled in the housing of the mirror and through the rubber grommet that is between the mirror and the vehicle chassis, as shown in Fig 4.

### NOTICE:

Installers and users must comply with all applicable federal, state and local laws regarding use and installation of warning devices.

*Improper use or installation may void warranty coverage.*

To review our Limited Warranty Statement & Return Policy for this or any SoundOff Signal product, visit our website at [www.soundoffsignal.com/tech-services/returns/](http://www.soundoffsignal.com/tech-services/returns/).

If you have questions regarding this product, contact **Technical Services**, Monday - Friday, 8 a.m. to 5 p.m. ET at 1.800.338.7337 (press #4).

Questions or comments that do not require immediate attention may be emailed to [techservices@soundoffsignal.com](mailto:techservices@soundoffsignal.com).

# SoundOff Signal

1.800.338.7337 / [www.soundoffsignal.com](http://www.soundoffsignal.com)

# PMP1BKUMB4-(x) - Under Mirror Mount Bracket Kit (each) 2021-2023 Chevrolet Tahoe Police Pursuit & Civilian Vehicles

For 3" mpower® Quick Mount

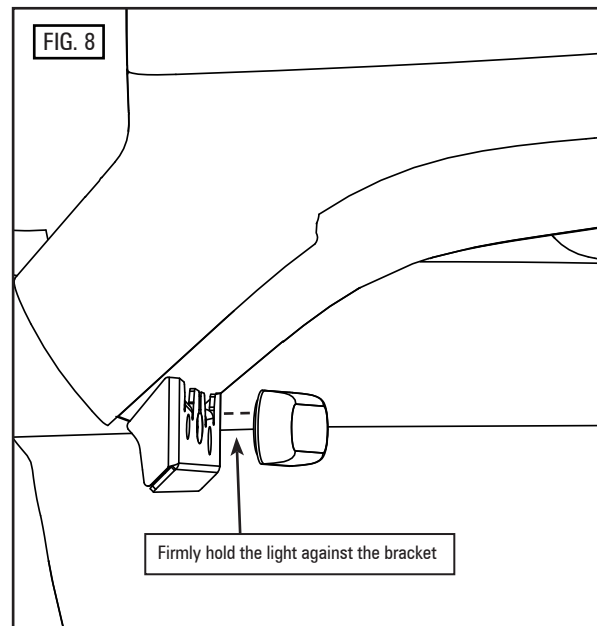
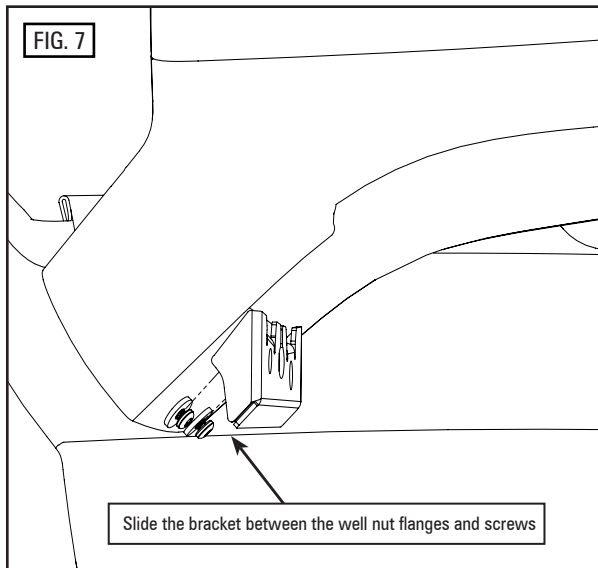
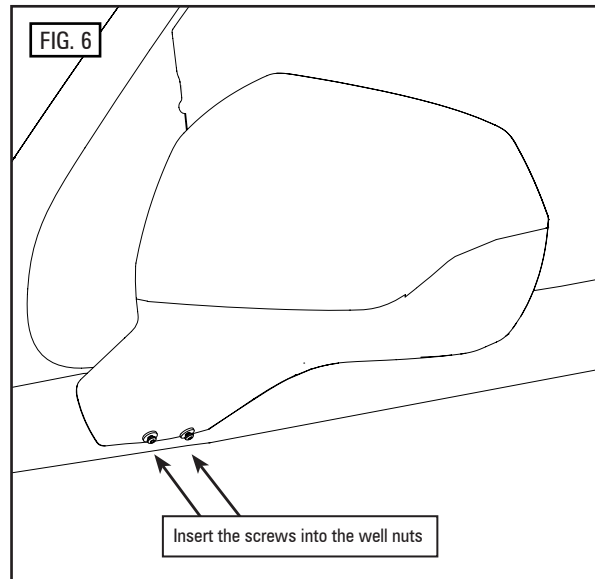
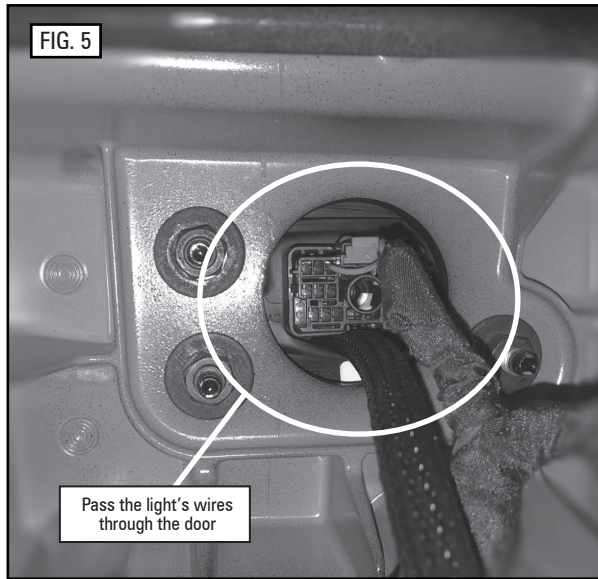

## INSTALLATION (CONT.)

5. Pass the light's wires into the door and attach the mirror to the door, as seen in Fig 5.
6. Place the included neoprene well nuts in the outermost holes that were previously drilled. Insert the screws into the well nuts and only thread them in enough so that they do not fall out, as seen in Fig 6.
7. Slide the bracket between the well nut flanges and the screws that are partially threaded in, as shown in Fig. 7. Adjust the bracket until it is in its final location and firmly press the bracket against the mirror while screwing the screws farther into the well nut.

**PRO TIP: Apply a torque of 6 in-lbs to the screw.**

8. Verify that the bracket is rigidly attached to the mirror.
9. Use the surface prep wipe included with the mpower light to clean the surface of the bracket. Tuck the extra wire into the bracket or mirror housing and attach the mpower quick mount light. Firmly hold the light against the bracket for 30 seconds to allow the adhesive on the light to bond to the bracket properly, as seen in Fig. 8.
10. The end result should look like the image, as shown in Fig. 9.

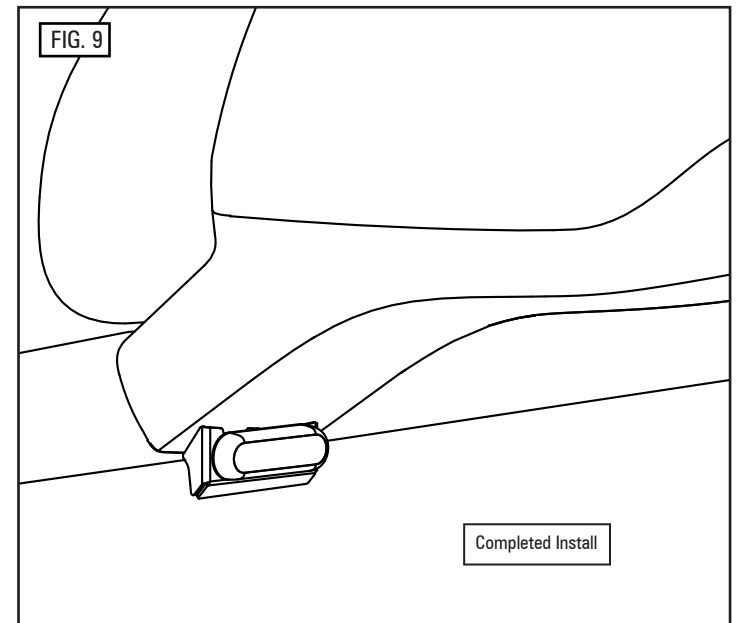

**SoundOff**  
**Signal**

1.800.338.7337 / www.soundoffsignal.com