

# 100C/100J/100N SERIES SPEAKER BRACKET (NO DRILL) FOR THE DODGE CHARGER 2015 - 2023, BUMPER MOUNT CENTER

ETSS100CBKDC15

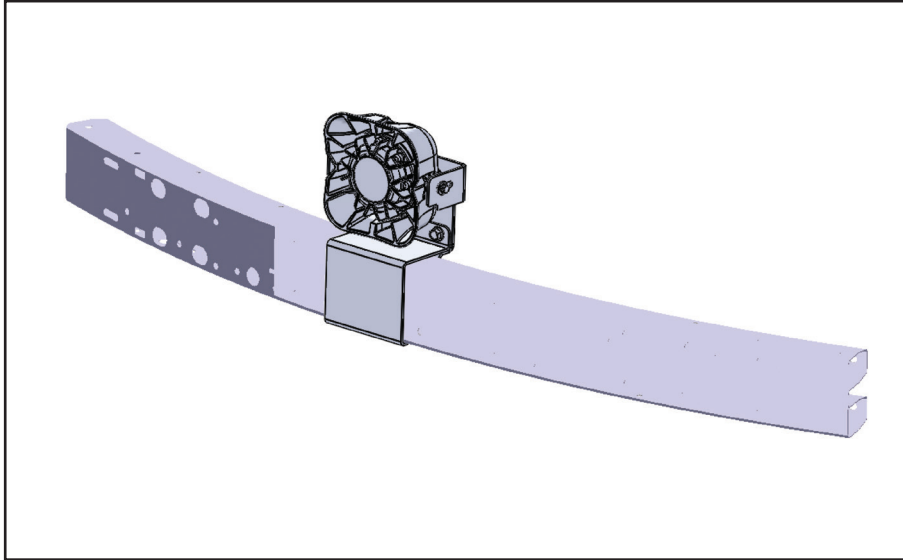

## BRACKET COMPATIBLE WITH SPEAKERS:

- 100C
- 100N
- 100J

## ⚠️ WARNING

- Sirens produce loud sounds that may damage hearing
- | Roll up windows
  - | Wear hearing protection
  - | Use only for emergency response
  - | Avoid exposure to siren sound outside of vehicle



## IMPORTANT

**TO AVOID DAMAGE TO SPEAKER USE THE SUPPLIED PLASTIC WASHERS ON BOTH SIDES OF METAL BRACKET. FOLLOW INSTRUCTIONS ON NEXT PAGE.**

ASSEMBLY SHOWN IS REPRESENTATIVE ONLY. EACH SPEAKER IS SLIGHTLY DIFFERENT AND INSTALLER IS RESPONSIBLE FOR SECURE MOUNTING IN BRACKET.

## ⚠️ WARNING

- HIGH CURRENT interconnects must be properly terminated. Poor crimp quality can cause heat build-up and fire. Follow crimp connector manufacturer instructions.
- DO NOT install this product or route any wires in the Air Bag Deployment Zone. Refer to vehicle Owner's Manual for deployment zones.
- Do NOT use system to disconnect headlights, brake lights or other safety equipment.
- Unit may become hot to touch during normal operation.
- Failure to properly install connectors, fuses or wiring may cause vehicle failure or fire.
- Installation must only be performed by trained technician. Installer must determine vehicle wiring configuration and proper integration of system.
- Use proper wire gauge. All power wires connecting to positive (+) or negative (-) battery terminal or local chassis ground (-) must be sized to supply at least 125% of max. current and properly fused at power source.
- Install protective grommets when routing wire through firewall or metal.

## TECHNICAL SPECIFICATIONS

Material:	Steel with powder coated black finish
Dimensions (bracket only):	11"H x 7.3"W x 4.5"D

## NOTICE:

Installers and users must comply with all applicable federal, state and local laws regarding use and installation of warning devices.

*Improper use or installation may void warranty coverage.*

To review our Limited Warranty Statement & Return Policy for this or any SoundOff Signal product, visit our website at [www.soundoffsignal.com/tech-services/returns/](http://www.soundoffsignal.com/tech-services/returns/).

If you have questions regarding this product, contact **Technical Services**, Monday - Friday, 8 a.m. to 5 p.m. ET at **1.800.338.7337** (press #4).

Questions or comments that do not require immediate attention may be emailed to [techservices@soundoffsignal.com](mailto:techservices@soundoffsignal.com).



# 100C/100J/100N SERIES SPEAKER BRACKET (NO DRILL) FOR THE DODGE CHARGER 2015 - 2023, BUMPER MOUNT CENTER

ETSS100CBKDC15

**1** REMOVE FRONT BUMPER COVER ASSEMBLY AS ONE PIECE AND NOT INDIVIDUALLY. CONSULT A LOCAL CHRYSLER SERVICE CENTER FOR BEST DISASSEMBLY METHOD.

-KEEP ALL HARDWARE-

**2**

BACK VIEW OF FRONT BUMPER ASSEMBLY

RECOMMENDED SPEAKER BRACKET LOCATIONS

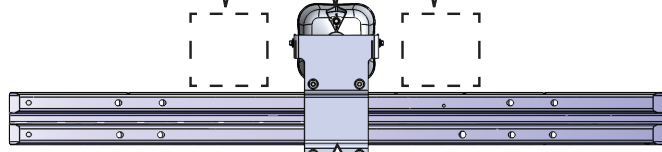

POSITION SPEAKER BRACKET ON THE IMPACT BAR SO THAT SPEAKER WILL FACE FORWARD.

**3**

SPEAKER BRACKET ASSEMBLY

MARK THE PLASTIC SHELL OF THE BUMPER AS SHOWN. NOTCH PLASTIC TO ALLOW BUMPER TO BE REPOSITIONED BACK ON VEHICLE WITH SPEAKER BRACKET ASSEMBLY.

FRONT BUMPER SHOWN ONLY

**4**

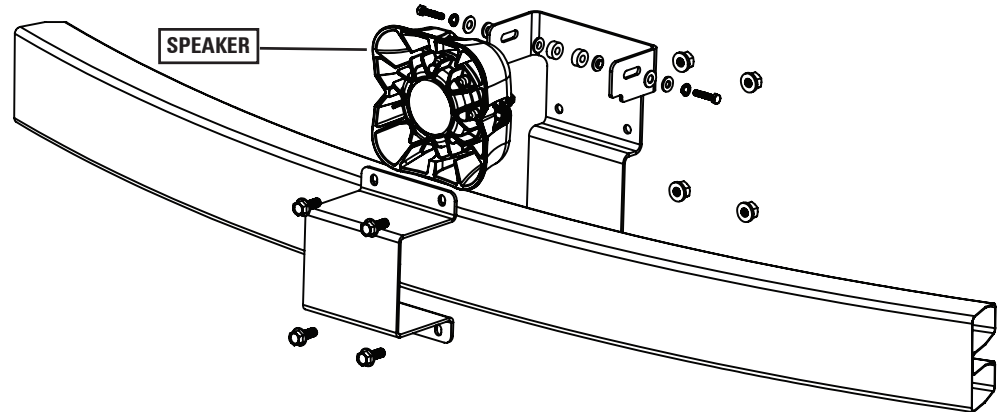

-ASSEMBLE AS SHOWN-  
PARTS WILL VARY DEPENDING ON SPEAKER.  
SEE STEP 5

**SoundOff**  
**Signal** 

1.800.338.7337 / www.soundoffsignal.com

# 100C/100J/100N SERIES SPEAKER BRACKET (NO DRILL) FOR THE DODGE CHARGER 2015 - 2023, BUMPER MOUNT CENTER

ETSS100CBKDC15

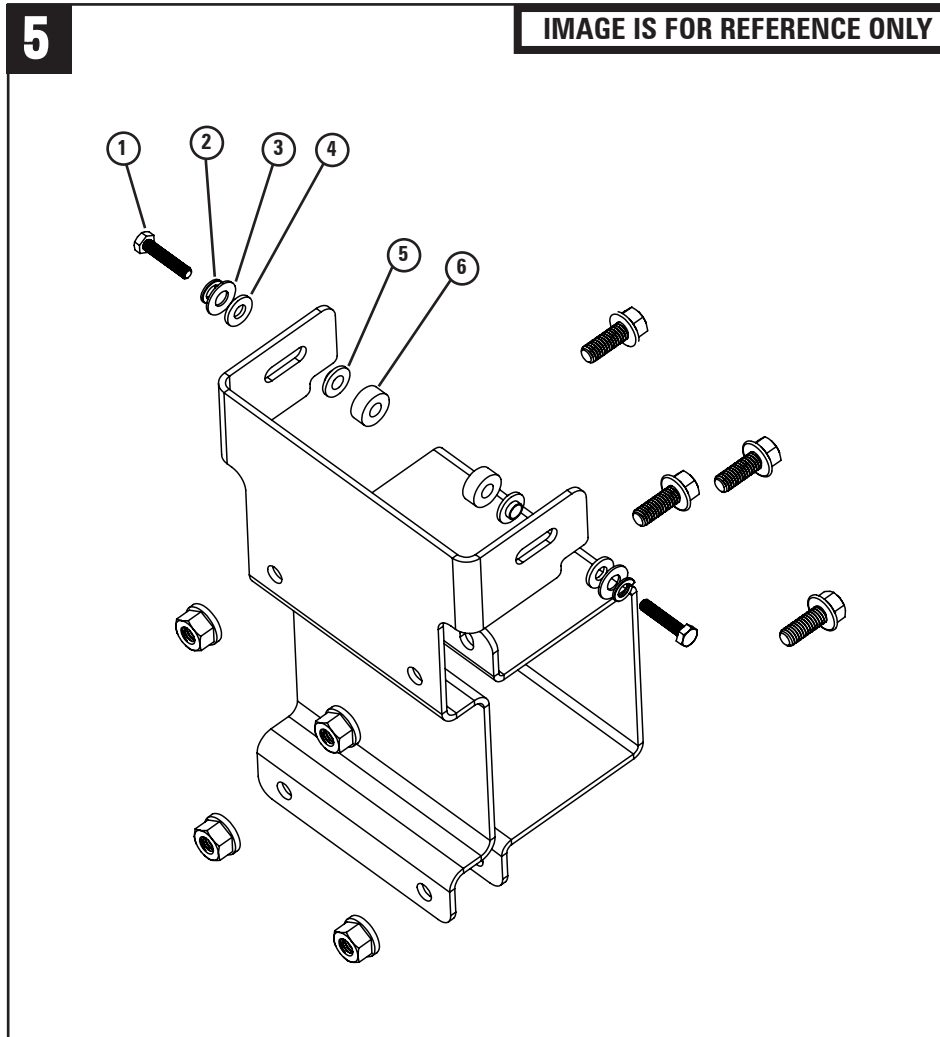

100N HARDWARE	
ITEM#	DESCRIPTION
1	M6X30MM SS BOLT
2	SS LOCK WASHER
3	SS WASHER
4	OUTER PLASTIC WASHER
5	INNER PLASTIC WASHER
6	0.5" PLASTIC SPACER

100J HARDWARE	
ITEM#	DESCRIPTION
1	M6X30MM SS BOLT
2	SS LOCK WASHER
3	SS WASHER
4	OUTER PLASTIC WASHER
5	INNER PLASTIC WASHER
6	0.31" PLASTIC SPACER

100C HARDWARE	
ITEM#	DESCRIPTION
1	1/4" - 20X0.75" SS BOLT
2	SS LOCK WASHER
3	SS WASHER
4	OUTER PLASTIC WASHER
5	INNER PLASTIC WASHER
6	NOT USED



# 100C/100J/100N SERIES SPEAKER BRACKET (NO DRILL) FOR THE DODGE CHARGER 2015 - 2023, BUMPER MOUNT CENTER

ETSS100CBKDC15

## **100N** **IMPORTANT**

HARDWARE SAME AS 100H SPEAKERS

**\*EXCEPT USE M6 BOLTS PROVIDED WITH KIT\***

**7**

### **NOTE**

VERIFY THE CORRECT HARDWARE IS BEING USED DEPENDING ON THE MODEL SPEAKER LISTED ON PREVIOUS PAGE BEFORE PROCESSING TO NEXT STEP.

**8**

WIRE SPEAKER TO SIREN OUTPUT AND TEST

**9**

RE-INSTALL FRONT BUMPER COVER ASSEMBLY USING PREVIOUSLY REMOVED HARDWARE

