

3900 Central Parkway  
Hudsonville, MI 49426  
toll free 800.338.7337  
office 616.896.7100

techsupport@soundoffsignal.com  
www.soundoffsignal.com

**WARNING:** Warning devices are strictly regulated and governed by Federal, State and Municipal ordinances. These devices shall be used ONLY on approved vehicles. It is the sole responsibility of the user of these devices to ensure compliance.

## FORD CROWN VICTORIA POLICE INTERCEPTOR Plug-in Flasher Installation Instructions

### Operating Specifications:

10-16 Vdc Input  
Reverse polarity protected with 10amp in-line Mini ATO Fuse  
Output: 55 Watt Load on each of 2 outputs  
High Beam Override, disables flasher when high beams are activated

Night Time Cutoff, disables flasher when low beams are activated if required by local regulations

Less than 10mA standby current  
Fuse: Mini ATO 10 Amp

### Mounting Instructions:

1. Remove radiator shroud by removing the 3 retaining screws.
2. Place flasher onto the cross brace to the left (driver's side) of the shroud mounting hole. (See detail)
3. Using the bracket and flasher as a template, drill pilot holes in the top of the cross member.
4. Attach bracket to cross member by installing screws. **DO NOT OVERTIGHTEN.**
5. Make electrical connections and test.

# 2002-2005 FORD POLICE INTERCEPTOR PLUG-IN FLASHER

with 25" wire leads #ETHIFP0

### ELECTRICAL INSTALLATION INSTRUCTIONS

1. Locate the 3 pin connector in front of the radiator under the cross brace.
2. Remove the loop connector and store for future use if flasher is ever removed from vehicle.
3. Carefully route the 3 wire harness (Yellow, Green and Blue wires) with connector to the vehicle's mating connector making sure the harness will not interfere with moving vehicle components and will not get damaged in field operation. Connect flasher with mating vehicle connector.
4. Carefully route the 5 wire harness (Red, Black, Orange, White, Brown) behind the headlight and around the battery, making sure the harness will not interfere with moving vehicle components and will not get damaged in field operation.
5. Wire Connections:
  - a. Black - Connect to a reliable ground, preferably to ground terminal of battery.
  - b. Red - Connect to power distribution post as shown at right. **IMPORTANT:** Do Not remove Mini ATO fuse holder as this provides protection in the event of a failure or short circuit.
  - c. Brown - Night Time Cutoff.  
If not required, cut and tape end with electrical tape. If required, "T" or tap into the vehicle's low beam headlight wire.
  - d. Orange - Connect to +12Vdc to activate flasher.
  - e. To change patterns touch white wire to ground.

FLASH PATTERN MATRIX	
Flash Pattern Sequence	FPM (Flashes / Minute)
1-RoadRunner™	115 f.p.m.
2-PowerPulse™	180 f.p.m.
3-ETM™	215 f.p.m.
4-Double Flash	50 f.p.m.
5-Q-Switch™	Multi-Pattern
6-Cycle Flash	Multi-Pattern
7-Single Flash	56 f.p.m.

### FINISHING THE INSTALLATION:

1. Test vehicle operation:
  - a. Turn flasher ON by supplying power to the Orange wire to ensure correct flash pattern is selected.
  - b. While flasher is ON, activate high beam headlight switch and verify high beams are both on.
  - c. If Night Time Cutoff is required, activate low beam headlight switch and verify low beams are ON. Then turn flasher ON and verify flasher does not operate.
2. Replace radiator shroud.

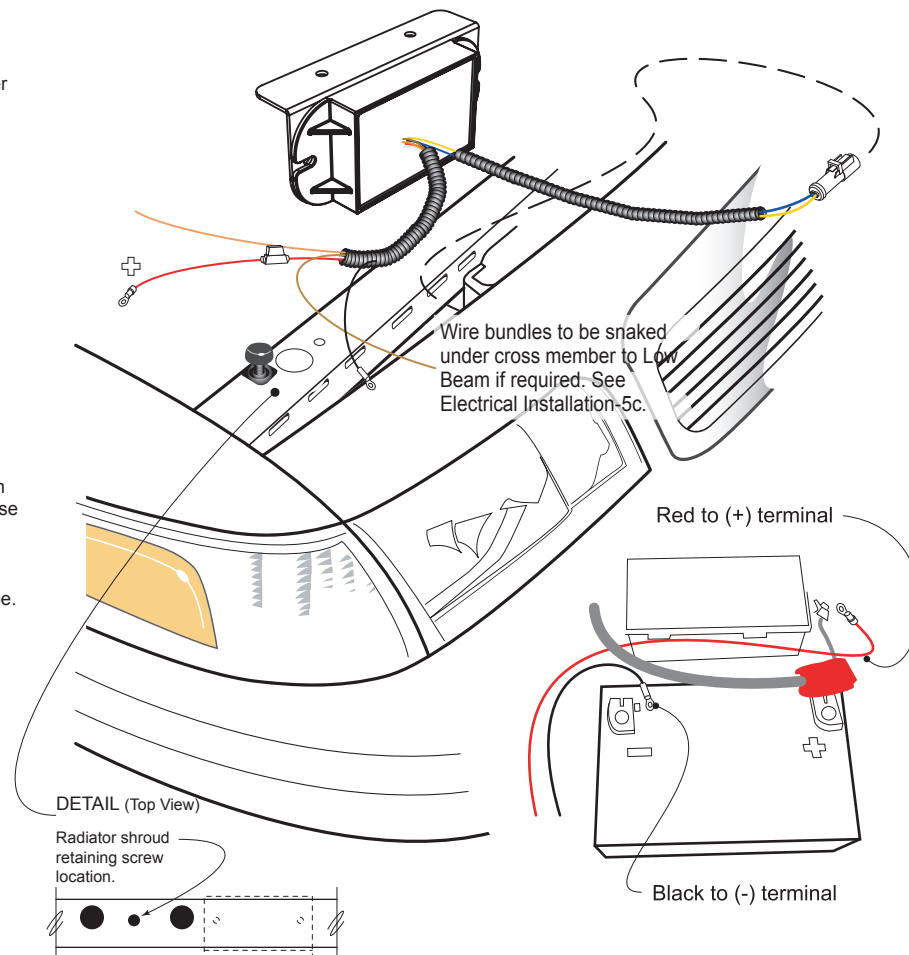

DETAIL (Top View)

Radiator shroud retaining screw location.

Bracket with flasher attached is to be mounted just left of holes in cross-member.

### NOTE

Flashing Headlight and Taillight Systems are intended for use on approved vehicles ONLY. It is the responsibility of the user of these systems to insure compliance to any Federal, State or Municipal regulations which may apply.

### NO HASSLE WARRANTY

SoundOff Signal warrants the Headlight Flasher System for five (5) full years from the date of purchase to the original purchaser against any manufacturing defects or workmanship. This warranty applies only to units installed according to the manufacturer's installation instructions and operated within the unit's specifications.

Warranty is void if the unit was installed incorrectly or maliciously damaged.

All warranty claims must be accompanied by a dated proof of purchase.

SoundOff Signal retains the right to be the sole mediator of what constitutes defects in performance or manufacturing.